



Middleton Drive, London, SE16 6RZ

A spacious five bedroom, three bathroom house; located a walk away from both Canada Water and Rotherhithe station, offering excellent transport links across London. The ground floor boasts a generous kitchen, dining and reception room with access to the large private garden, a double bedroom with built-in storage, modern shower room with storage, and additional storage in the hallway. The first floor boasts two spacious double bedrooms and a sleek family bathroom. The top floor has two large double bedrooms, one with en-suite bathroom and the other with plenty of storage. The house is surrounded by many local amenities such as cafes, restaurants, bars, supermarkets, shopping centre, local markets and the greenery of Stave Hill Ecological Park.

- Spacious Five Bedroom House
- Large Private Garden
- Excellent Transport Links
- Surrounded by Local Amenities
- Furnished

Alex & Matteo
ESTATE AGENTS

£4,500 Per month

Middleton Drive SE16

Approximate Area = 1629 sq ft / 151.3 sq m

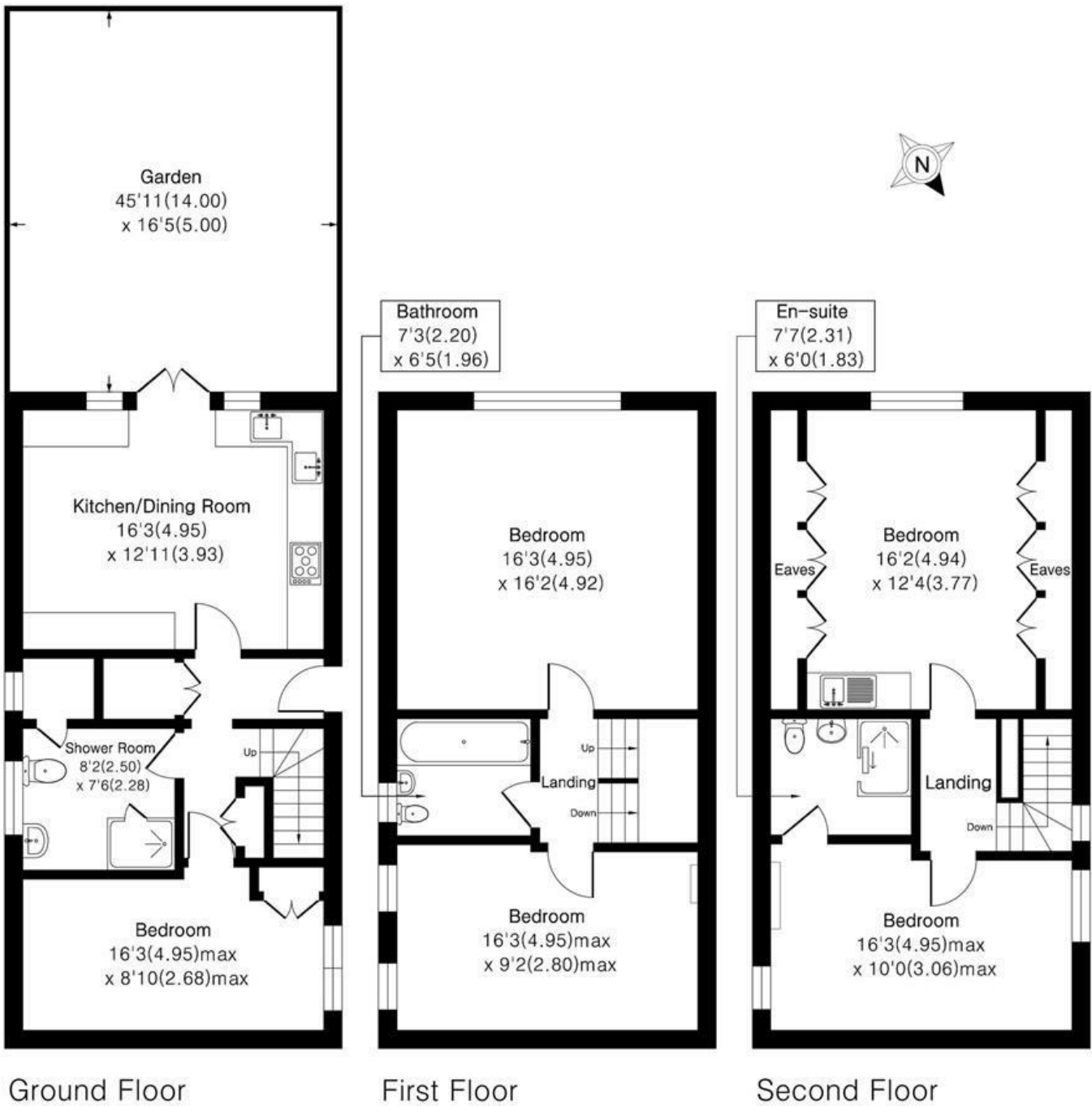

Floor plan Produced in accordance with RICS Property Measurement 2nd Edition.
Incorporating International Property Measurement Standards (IPMS2 Residential).
Produced for Alex & Matteo Estate Agents.

Energy Efficiency Rating		
	Current	Potential
Very energy efficient - lower running costs		
(92 plus) A		
(81-91) B		
(69-80) C	71	80
(55-68) D		
(39-54) E		
(21-38) F		
(1-20) G		
Not energy efficient - higher running costs		
England & Wales		
EU Directive 2002/91/EC		